

**CONTACT INFORMATION**

- Website: [www.supermicro.com](http://www.supermicro.com)
- General Information: [marketing@supermicro.com](mailto:marketing@supermicro.com)
- Technical Support: [support@supermicro.com](mailto:support@supermicro.com)
- Phone: +1 (408) 503-8000, Fax: +1 (408) 503-8008

**FOR YOUR SYSTEM TO WORK PROPERLY, PLEASE DOWNLOAD APPROPRIATE**

- DRIVERS/IMAGES/USER'S MANUAL FROM THE LINKS BELOW:**
- Manuals: <http://www.supermicro.com/support/manuals>
  - Drivers & Utilities: [ftp://ftp.supermicro.com/CDR\\_Images/CDR-X11-UP/](ftp://ftp.supermicro.com/CDR_Images/CDR-X11-UP/)
  - Safety: [http://www.supermicro.com/about/policies/safety\\_information.cfm](http://www.supermicro.com/about/policies/safety_information.cfm)

**PACKAGE CONTENTS**

- One (1) Supermicro Motherboard
- Six (6) SATA Cables
- One (1) I/O Shield
- One (1) Quick Reference Guide



**Motherboard Layout and Features**

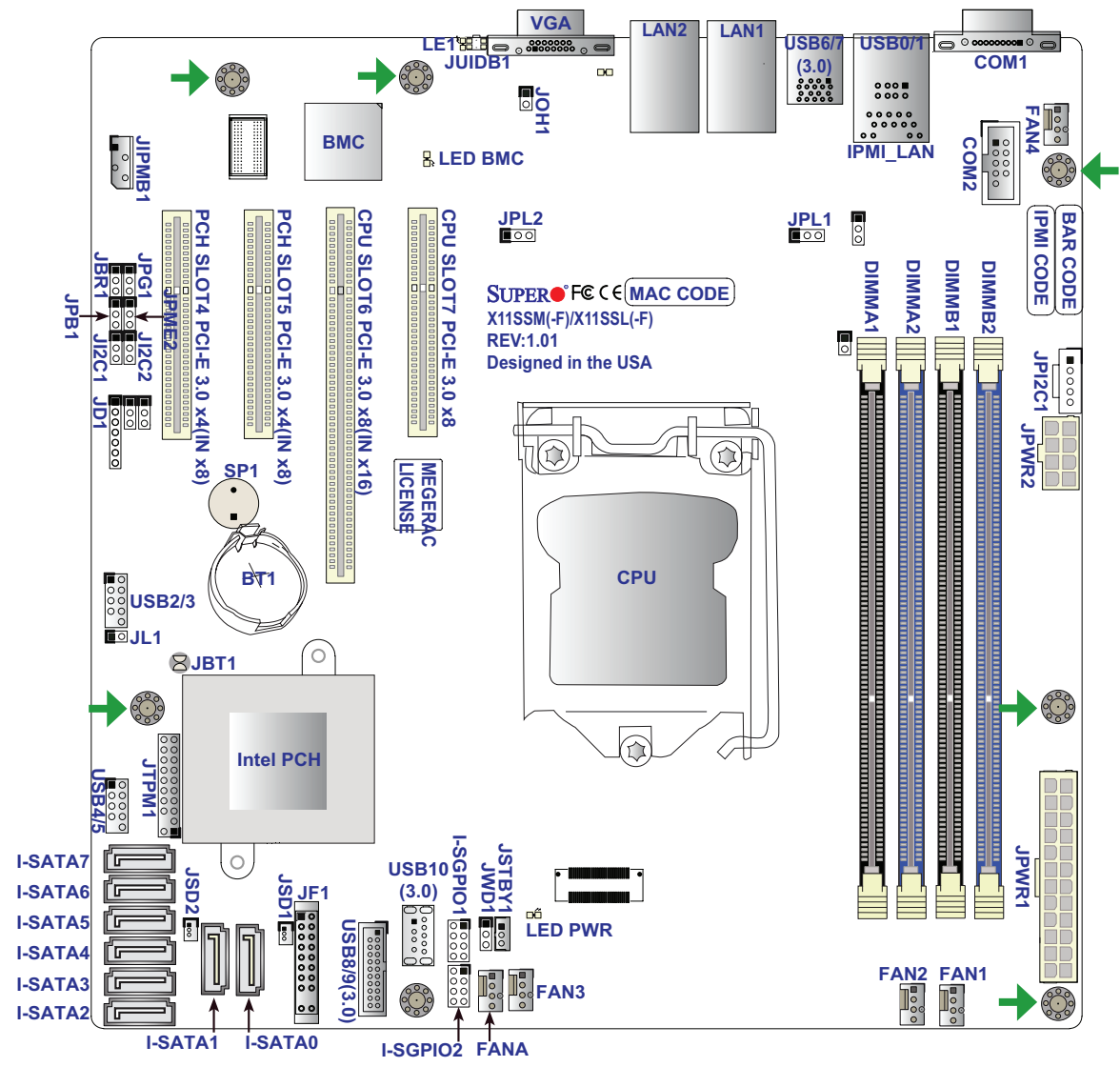

**Jumpers and Connectors**

Jumpers		
Jumper	Description	Default
JBR1	BIOS Recovery	Pins 1-2 (Normal)
JBT1	Clear CMOS	See Chapter 2
JPC1/JPC2	SMB to PCI Slots	Pins 1-2 (Enabled)
JPB1	BMC Enable/Disable	Pins 1-2 (Enabled)
JPG1	VGA Enable	Pins 1-2 (Enabled)
JPL1/JPL2	LAN1/LAN2 Enable	Pins 1-2 (Enabled)
JPME2	Manufacturing Mode Select	Pins 1-2 (Normal)
JWD1	Watch Dog Enable	Pins 1-2 (Reset)

Connectors	
Connector	Description
BT1	Onboard Battery
COM1	COM1 Port Header
COM2	COM2 Port Header [X11SSM(-F) only]
FAN1-FAN4, FANA	System/CPU Fan Headers
IPMI_LAN	IPMI_Dedicated Gigabit (RJ45) Port (X11SSM-F & X11SSL-F only)
I-SATA0-I-SATA5	(Intel PCH) Serial ATA (SATA) 3.0 Ports
I-SATA6 & I-SATA7	(Intel PCH) Serial ATA (SATA) 3.0 Ports [X11SSM(-F) only]
I-SGPIO 1/2	Serial_Link General Purpose I/O Connection Headers 1/2
JD1	Speaker/Power LED Indicator
JF1	Front Panel Control Header
JIPMB1	4-pin External BMC I <sup>2</sup> C Header (for an IPMI Card)
JL1	Chassis Intrusion Header
JPIPC1	Power System Management Bus (Power SMB)
JOH1	Overheat LED Indicator
JPWR1	24-pin ATX Main Power Connector (Required)
JPWR2	+12V 8-pin Power Connector (Required)
JSD1/JSD2	SATA DOM (Device_On_Module) Power Connectors
JSTBY1	Inject External P5V_STBY Power
JTPM1	Trusted Platform Module/Port 80 Connector
JUIDB1	Unit Identifier Switch
LAN1/LAN2	Gigabit (RJ45) Ports (LAN1/2)
PCI-E (PCH) Slot 4	PCI-Express 3.0 x4in x8 Slot [X11SSM(-F) only]
PCI-E (PCH) Slot 5	PCI-Express 3.0 x4in x8 Slot
PCI-E (CPU) Slot 6	PCI-Express 3.0 x8in x16 Slot
PCI-E (CPU) Slot 7	PCI-Express 3.0 x8 Slot
SP1	Internal Speaker/Buzzer
USB 0/1	Back Panel USB 2.0 Ports
USB 2/3	Front Accessible USB 2.0 Headers
USB 4/5	Front Accessible USB 2.0 Headers
USB 6/7	Back Panel USB 3.0 Ports
USB 8/9	Front Accessible USB 3.0 Header
USB 10	USB 3.0 Type-A Header
VGA	Back Panel VGA Port

**LED Indicators**

LED Indicators			
LED	Description	Color/State	Status
LE1	Rear UID LED	Blue: On	Unit Identified
LEDBMC	BMC Heartbeat LED	Green: Blinking	BMC Normal
LEDPWR	Onboard Power LED	Green: Solid on	Power On

**Memory Support**

The X11SSM(-F) / X11SSL(-F) motherboard supports up to 64GB of DDR4 ECC UDIMM memory at a speed of up to 2400MHz in four memory slots. Populating these DIMM slots with a pair of memory modules of the same type and size will result in interleaved memory, which will improve memory performance.

**DIMM Memory Installation**

When installing memory modules, the DIMM slots should be populated in the following order: DIMMB2, DIMMA2, then DIMMB1, DIMMA1. Populate the blue slots first. See the motherboard layout on the left for the location of the DIMM slots.

- Always use DDR4 DIMM modules of the same type, size, and speed.
- Mixed DIMM speeds can be installed. However, all DIMMs will run at the speed of the slowest DIMM.
- The motherboard will support odd-numbered modules (1 or 3 modules installed). However, for best memory performance, install DIMM modules in pairs to activate memory interleaving.

Recommended Population (Balanced)				
DIMMA1	DIMMB1	DIMMA2	DIMMB2	Total System Memory
		2GB	2GB	4GB
2GB	2GB	2GB	2GB	8GB
		4GB	4GB	8GB
4GB	4GB	4GB	4GB	16GB
		8GB	8GB	16GB
8GB	8GB	8GB	8GB	32GB
		16GB	16GB	32GB
16GB	16GB	16GB	16GB	64GB

**CPU Installation**

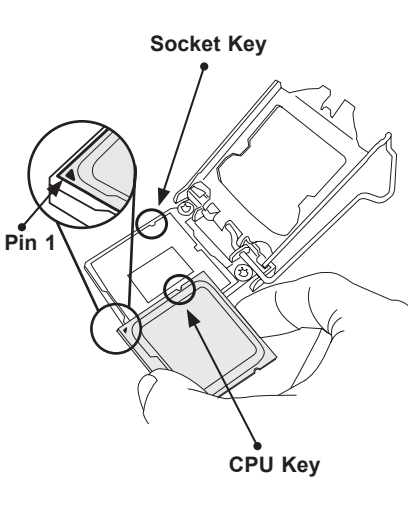

**Heatsink Installation**

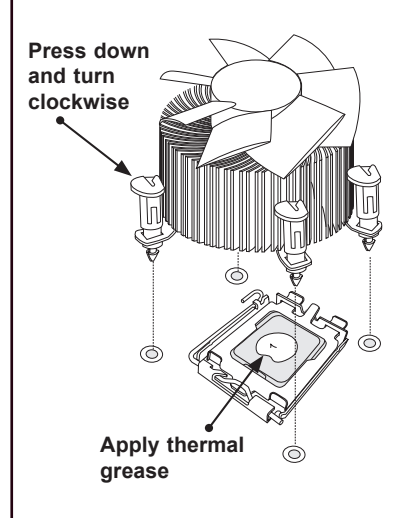

**Front Panel Control (JF1)**

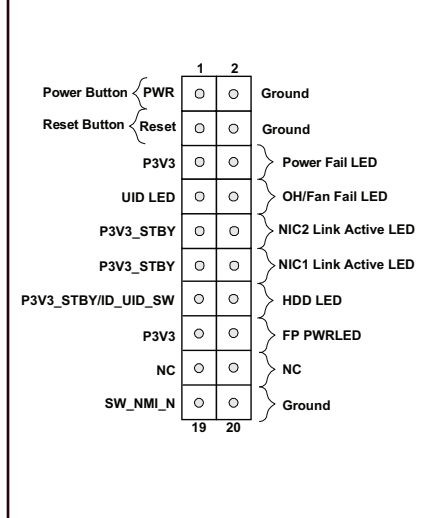

**CPU Support**

The X11SSM(-F) / X11SSL(-F) motherboard supports an Intel Xeon E3-1200 v6/v5, 7th/6th Gen Core i3, Pentium, and Celeron series processor in an LGA1151 socket.

**Back Panel I/O Connectors**

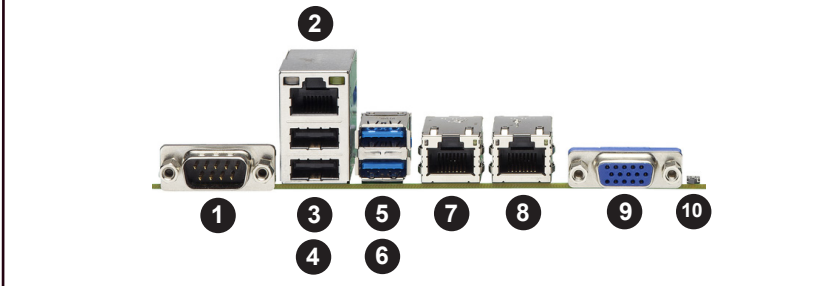

#	Description	#	Description
1	COM1	6	USB6 (3.0)
2	Dedicated IPMI LAN	7	LAN1
3	USB1 (2.0)	8	LAN2
4	USB0 (2.0)	9	VGA Port
5	USB7 (3.0)	10	UID Switch

**Note:** Graphics shown in this quick reference guide are for illustration only. Your components may or may not look exactly the same as drawings shown in this guide.

**Note:** Refer to Chapter 1 of the User Manual for detailed information on jumpers, connectors, and LED indicators.

**Note:** Refer to Chapter 2 of the User Manual for detailed information on memory support and CPU/motherboard installation instructions.